

Main Fuse:

The main fuse (1) is located near the battery.

The specified fuse is:

15A

1. Open the seat (page 39).
2. Remove the battery cover and starter magnetic switch cover (page 97).
3. Disconnect the wire connector (2) of the starter magnetic switch (3).
4. Pull the fuse out. If the main fuse is blown, install a new main fuse.
The spare main fuse (4) is located on reverse side of the battery cover (5).
5. Reconnect the wire connector and install the battery cover and starter magnetic switch cover.
6. Close the seat.

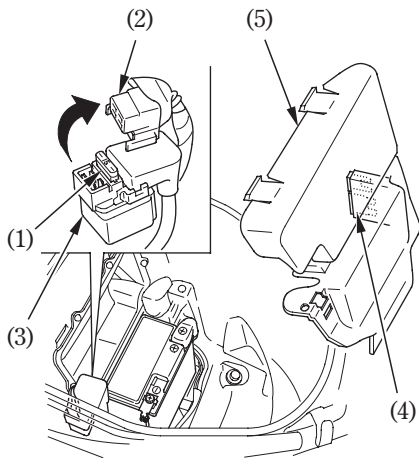

- (1) Main fuse
- (2) Wire connector
- (3) Starter magnetic switch
- (4) Spare main fuse
- (5) Battery cover