

HELMET HOLDER

The helmet holder is located below the rear seat.

Remove the rear seat (page 47). Route the helmet wire (1) through the helmet D-ring (2) and hook the loops of the helmet wire onto the helmet holder (3).

Install the rear seat and lock it securely.

! WARNING

Riding with a helmet attached to the holder can interfere with the rear wheel or suspension and could cause a crash in which you can be seriously hurt or killed.

Use the helmet holder only while parked. Do not ride with a helmet secured by the holder.

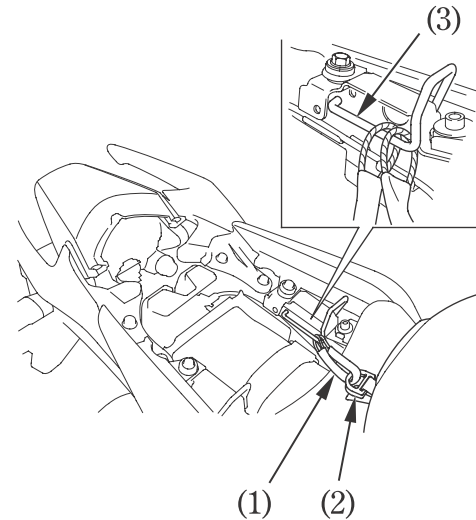

- (1) Helmet wire
- (2) Helmet D-ring

- (3) Helmet holder