

## Brake/Tail Light Bulb

1. Remove the rear seat (page 47 ).
2. Turn the socket (1) counterclockwise, and remove it.
3. Slightly press the bulb (2) and turn it counterclockwise.
4. Install a new bulb in the reverse order of removal.
5. Install the rear seat.

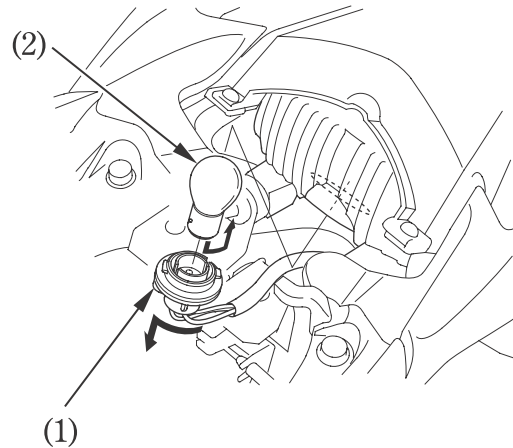

- (1) Socket  
(2) Bulb