

Clutch System

Clutch Spring Inspection

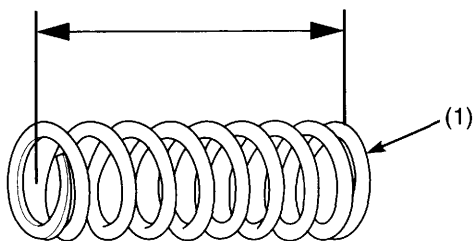

(1) clutch spring

Measure the free length of each spring.
Service Limit: 43.7 mm (1.72 in)

Replace the clutch springs as a set if any one of them is below the service limit or if the clutch plates have been burnt/heat discoloured.

Clutch Disc/Plate Installation

1. Coat the clutch plates with engine oil.
2. Install the eight clutch discs (2) and seven clutch plates (1) alternately, starting with a disc.

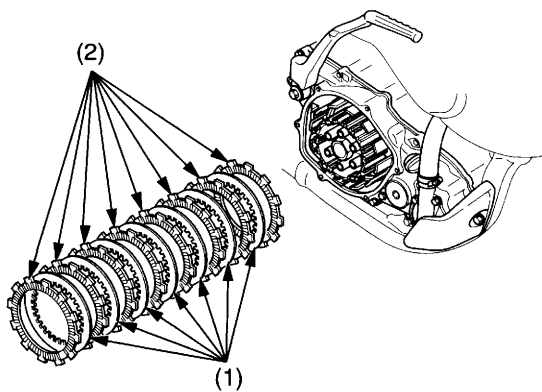

(1) seven clutch plates
(2) eight clutch discs

3. Apply grease to the clutch lifter rod (3).
4. Insert the clutch lifter rod into the mainshaft.
5. Apply engine oil to the needle bearing (4) and washer (5) and install them onto the clutch lifter (6).
6. Install the clutch lifter onto the rod.

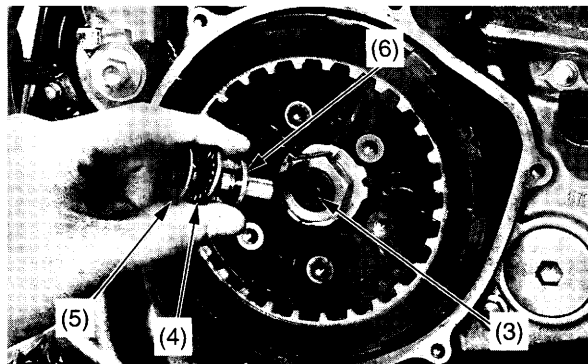

(3) clutch lifter rod
(4) needle bearing
(5) washer
(6) clutch lifter

7. Install the clutch pressure plate (7).
8. Install the six clutch springs and bolts (8).
9. Tighten the bolts in a crisscross pattern in two or three steps, to the specified torque:
12 N·m (1.2 kgf·m, 9 lbf·ft)

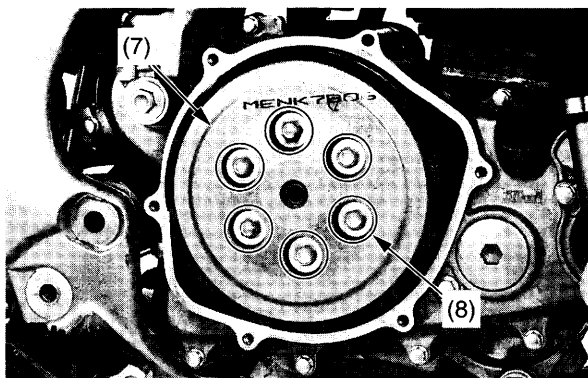

(7) clutch pressure plate
(8) clutch springs and bolts

10. Apply oil to a new O-ring (9) and install it in the groove of the clutch cover (10).
11. Install the cover by tightening the six cover bolts in a crisscross pattern in two or three steps to the specified torque:
10 N·m (1.0 kgf·m, 7 lbf·ft)

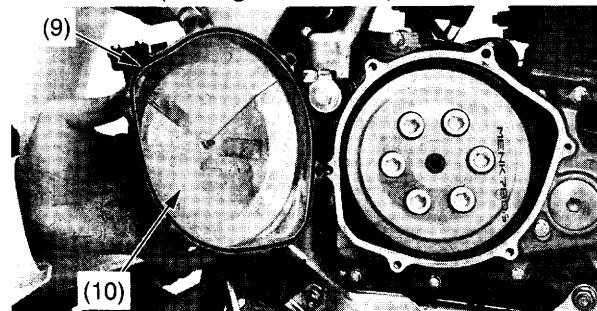

(9) O-ring
(10) clutch cover

12. Lubricate the dust seals (11), rear brake pedal (12) pivot and rear brake pedal pivot bolt (13) with Honda Lithium Grease or equivalent.
13. Apply locking agent to the brake pedal pivot bolt threads.
14. Install the dust seals into the rear brake pedal.
15. Install the pivot bolt with the washer (14) and tighten the pivot bolt to the specified torque:
36 N·m (3.7 kgf·m, 27 lbf·ft)
Connect the brake pedal return spring (15) if it was removed.

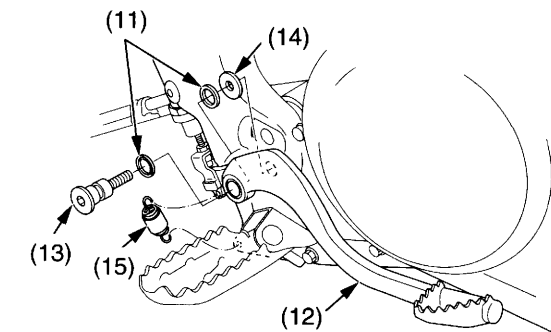

(11) dust seals
(12) rear brake pedal
(13) brake pedal pivot bolt
(14) washer
(15) brake pedal return spring

16. Fill the crankcase with transmission oil (page 40).