

SEAT

To remove the seat (1), insert the ignition key (2) into the lock (3) and turn it clockwise to unlock the seat.

Remove the seat.

To install the seat, insert the seat tab under the frame cross member and push down on the rear of the seat..

CAUTION:

* **Be sure the seat is locked securely in position after installation.**

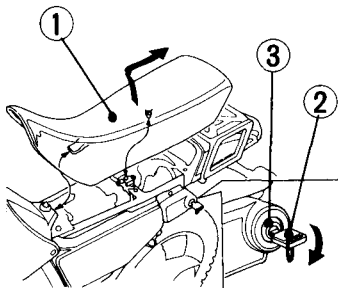

(1) Seat

(2) Ignition key

34

(3) Lock

DOCUMENT COMPARTMENT

The document compartment (1) is under the seat.

This owner's manual and other documents should be stored in the vinyl bag. When washing your motorcycle, be careful not to flood this area with water.

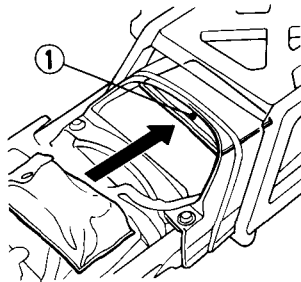

(1) Document compartment