

TOOL KIT

The tool kit (1) is in the tool box (2) behind the right side cover.

Remove the right side cover (page 31) and tool box lid (3).

Some roadside repairs, minor adjustments and parts replacement can be performed with the tools contained in the kit.

- 8x10 mm open end wrench
- 10x12 mm open end wrench
- 14x17 mm open end wrench
- Pliers
- Standard/Phillips screwdriver
- Screwdriver handle
- 22 mm box end wrench
- Pin spanner
- Extension bar
- Spark plug wrench
- Tool bag

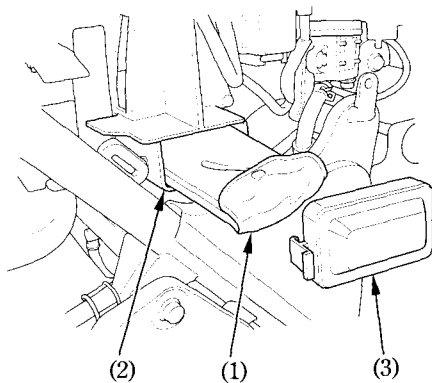

- (1) Tool kit
- (2) Tool box
- (3) Tool box lid