



## Engine Oil & Filter

8. If the oil level is near or below the lower level mark, remove the right side cover (5). Remove the oil filler cap (6) from the front right crankcase cover and add the specified oil into the filler cap hole, up to the upper level mark on the dipstick.

Do not over fill.

9. Reinstall the oil filler cap and dipstick.

10. Install the right side cover.

11. Install the left side cover.

12. Install the seat.

### NOTICE

*Running the engine with an improper oil level can cause serious engine damage.*

RIGHT SIDE

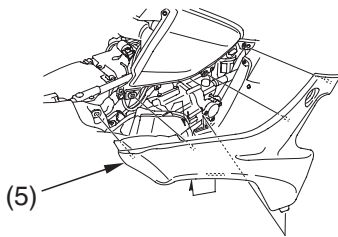

(5) right side cover

RIGHT SIDE

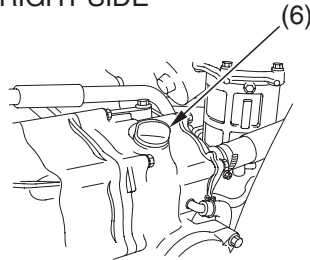

(6) oil filler cap

