

Engine Oil & Filter

9. Pour the drained oil into a suitable container and dispose of it in an approved manner (page 216).

NOTICE

Improper disposal of drained fluids is harmful to the environment.

Add Engine Oil:

10. Check that the drain plug sealing washer (6) and O-ring (7) are in good condition. If necessary, replace them.

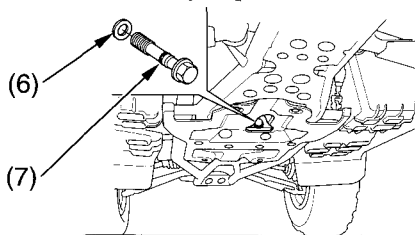

(6) drain plug sealing washer

(7) O-ring

11. Apply a thin coat of engine oil to the O-ring.
12. Reinstall the oil drain plug and tighten it to the specified torque:
18 lbf·ft (25 N·m , 2.5 kgf·m)
13. Fill the crankcase with the recommended grade oil approximately:
3.1 US qt (2.9 l)
14. Reinstall the oil filler cap.
15. Start the engine and let it idle for 5 minutes.
16. Stop the engine and after a few minutes, check the oil level. Make sure the oil is between the upper and lower level marks on the dipstick.
If necessary , add more oil but do not overfill.
17. Reinstall the oil filler cap and dipstick.
18. Check that there are no oil leaks.
If a torque wrench is not used for installation, see your Honda dealer as soon as possible to verify proper assembly.