



## Drive Chain

---

3. Inspect the drive chain for:

- damaged rollers
- loose pins
- dry or rusted links
- kinked or binding links
- excessive wear
- damaged or missing O-rings

Replace the drive chain (page 141) if it has damaged rollers, loose pins, or kinks that cannot be freed. Lubricate the drive chain (page 140) if it appears dry or shows signs of rust. Lubricate any kinked or binding links and work them free. Adjust chain slack if needed.

4. Check the drive chain slider (2) at the intervals specified in the Maintenance Schedule.

The chain slider must be replaced if it is worn to the wear limit line (3). For replacement, see your Honda dealer.

Replace the slider when the depth of the grooves reaches the limit.

Service limit:

**0.24 in (6.0 mm)**

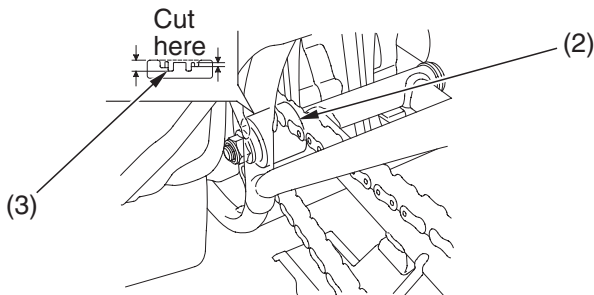

(2) drive chain slider

(3) wear limit line

