

SEAT/DOCUMENT BAG

The document bag (1) is in the storage compartment under the seat (2).

1. Insert the ignition key (6) into the lock (7) and turn it clockwise.
2. Pull the seat lock lever (8) downward to unlock the seat.

This owner's manual and other documents should be stored in the vinyl bag. When washing your motorcycle, be careful not to flood this area with water.

CAUTION:

- * **Be sure to securely lock the seat after installing it.**

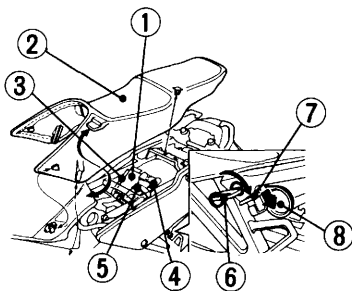

- | | |
|-------------------|------------------|
| (1) Document bag | (5) Tool bag |
| (2) Seat | (6) Ignition key |
| (3) Wheel wrench | (7) Lock |
| (4) Extension bar | (8) Lock lever |