

SEAT

The seat must be removed for the battery maintenance.

Seat removal:

1. Remove the three bolts (1).
2. Pull the seat assembly (2) back and up.

Seat installation:

1. Insert the seat tab (3) into the frame cross member (4).
2. Install and tighten the three bolts.

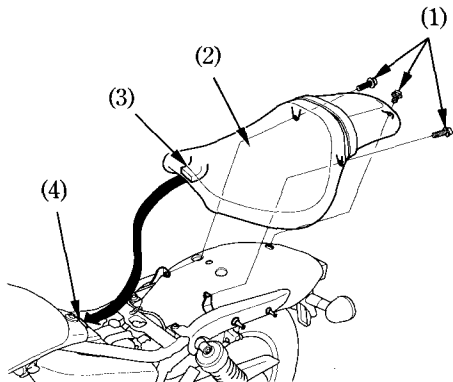

(1) Bolts
(2) Seat

(3) Seat tab
(4) Frame cross member