

Starting *(Continued)*

- 3 Squeeze the rear brake lever.
 - ▶ The starter motor will only work when the rear brake lever is squeezed and the side stand is up.
- 4 Press the start button with the throttle completely closed. Release the start button as soon as the engine starts.

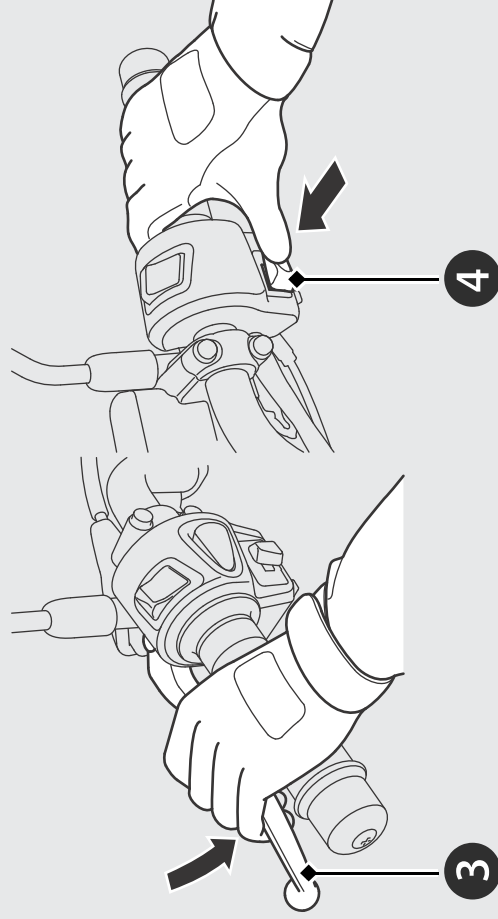

If you cannot start a warm engine:

- 1 Place the scooter on its centre stand and squeeze the rear brake lever.
- 2 Rotate the throttle $1/8 - 1/4$ turn while starting the engine.

$1/8 - 1/4$ turn

