

# Storage Equipment

The Helmet holder, helmet set wire (in the tool kit), tool kit, and document bag are located under the rear seat. There is also space to store a U-shaped lock.

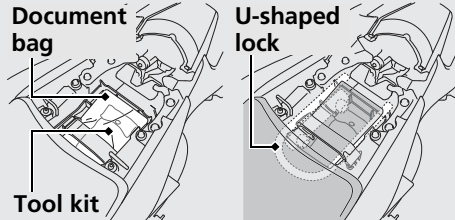
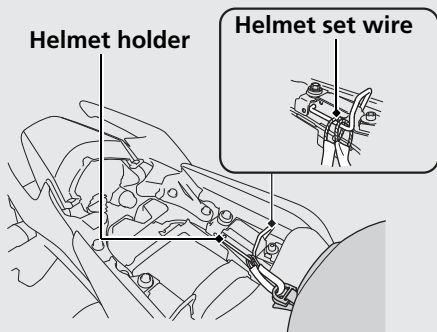

- ▶ Maximum Weight Limit: 6.6 lb (3.0 kg)
- ▶ The U-shaped lock is held in place above the rear fender.
- ▶ Use the helmet holder only when parked.
- ▶ Some U-shaped locks may not fit in the compartment due to their size or design.

**Removing the Rear Seat** ➔ P.49

## **⚠ WARNING**

Riding with a helmet attached to the holder can interfere with the rear wheel or suspension and could cause a crash in which you can be seriously hurt or killed.

Use the helmet holder only while parked. Do not ride with a helmet secured by the holder.