

# Switches

CRF1000A/A II

## Headlight dimmer/Passing light control switch

- ☰☐ : High beam
- ☷☐ : Low beam
- ☷☐ **PASS** : Flashes the high beam headlight.

## Ⓢ Torque Control switch

Torque Control level setting and Torque Control on/off. ➡ P.61

## 🔥 Handle grip heater switch

CRF1000A II

Change the handle grip heater level or turn the handle grip heater on and off. ➡ P.58

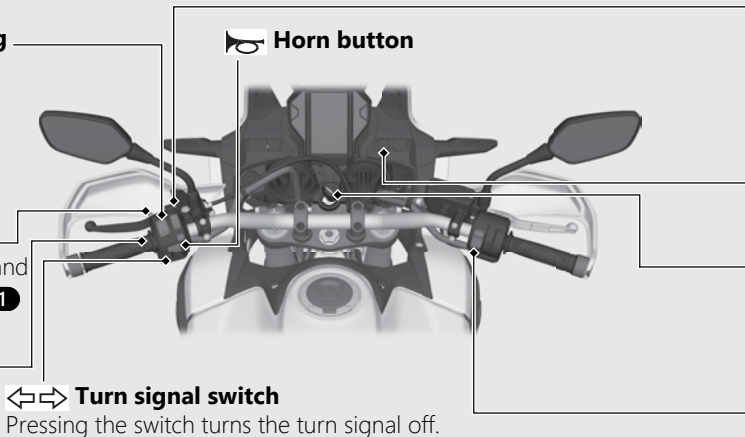

## ↔ Turn signal switch

Pressing the switch turns the turn signal off.