

4. Remove the engine oil fill cap (4) from the right crankcase cover.
5. Place an oil drain pan under the engine to catch the oil. Then remove the engine oil drain bolt (5) and sealing washer (6).

Note that more engine oil may splatter than the 2017 year model CRF250R.

6. With the engine stop button pushed, pull the clutch lever all the way in, and depress the start button to drain the engine oil completely.
7. After the oil has drained, apply engine oil to the drain bolt threads, seating surface and a new sealing washer, then tighten the drain bolt with the sealing washer installed to the specified torque:
12 lbf-ft (16 N-m, 1.6 kgf-m)

Pour the drained oil into a suitable container and dispose of it in an approved manner (page 146).

NOTICE

Improper disposal of drained fluids is harmful to the environment.

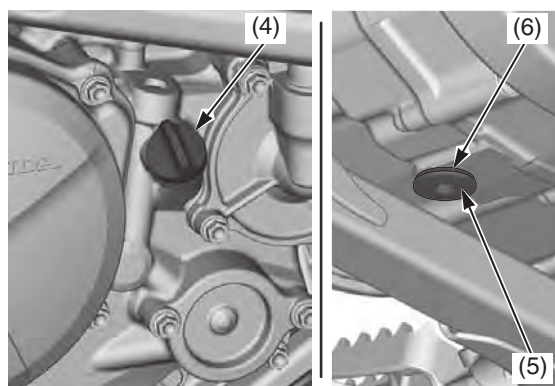

- (4) engine oil fill cap
- (5) engine oil drain bolt
- (6) sealing washer (new)

8. It is recommended to replace the oil and filter every 6 races or about every 15.0 hours. However, if you replace only the oil before the recommended interval, see page 25.
9. Remove the oil filter cover bolts (7) and oil filter cover (8).
10. Remove the oil filter (9) and O-ring (10) from the oil filter cover.
11. Remove the spring (11).

NOTICE

Using the wrong oil filter may result in leaks or engine damage.

12. Apply grease to the filter side of the spring end, then install the spring into a new oil filter.
13. Position the spring against the engine crankcase and install a new oil filter with the rubber seal (12) facing out, away from the engine. You should see the “OUT-SIDE” mark (13) on the filter body, near the seal. Use a new Honda Genuine oil filter or a filter of equal quality specified for your model.

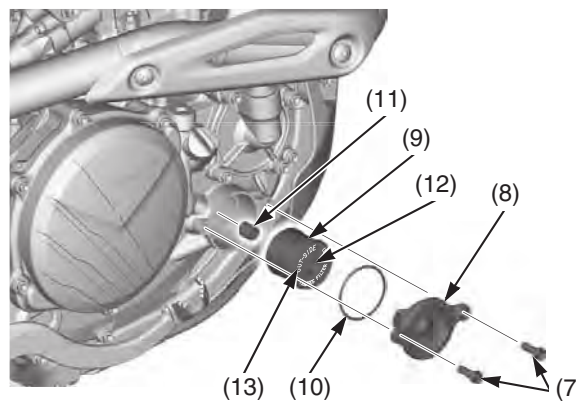

- (7) oil filter cover bolts
- (8) oil filter cover
- (9) oil filter (new)
- (10) O-ring (new)
- (11) spring
- (12) rubber seal
- (13) “OUT-SIDE” mark

NOTICE

If the oil filter is not installed properly, it will cause serious engine damage.

14. Apply engine oil to a new O-ring and install it to the oil filter cover.
15. Install the oil filter cover being careful not to damage the new O-ring, then tighten the oil filter cover bolts to the specified torque:
7 lbf-ft (10 N-m, 1.0 kgf-m)
16. Install the engine guard, then tighten the engine guard A bolts/washers and B bolt/washer to the specified torque:
7 lbf-ft (10 N-m, 1.0 kgf-m)
17. Fill the crankcase with the recommended oil.
Capacity:
1.18 US qt (1.12 ℓ) after draining and filter change
1.14 US qt (1.08 ℓ) after draining
18. Install the engine oil fill cap.
19. Check the engine oil level by following the steps in *Checking & Adding Oil* (page 52).

Pour the drained oil into a suitable container and dispose of it in an approved manner (page 146).

NOTICE

Improper disposal of drained fluids is harmful to the environment.