

iPod[®]/USB Flash Drive

USB Cable

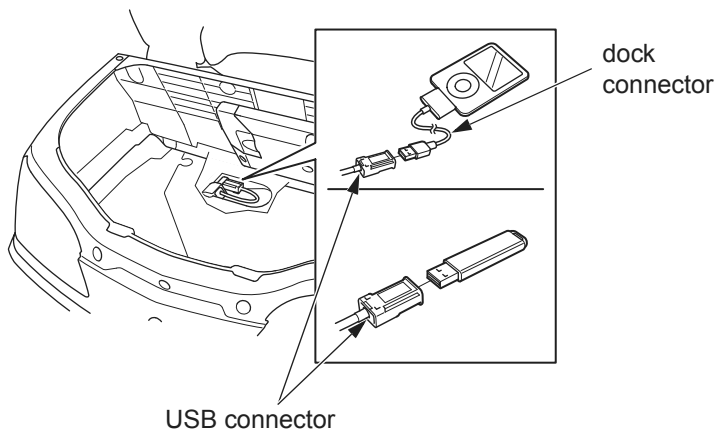

To connect

1. Open the trunk (see [page 53](#)) and turn over the trunk mat.
2. Unclip the USB connector.
3. Connect your iPod with dock connector or the USB flash drive to the USB connector.

To disconnect

You can disconnect the iPod[®]/USB flash drive at any time. Make sure to follow the iPod[®]'s instructions on how to disconnect the dock connector from the USB cable.

When you disconnect the iPod[®]/USB flash drive, the USB indicator will disappear.