

Basic Operation

Driving in Reverse

If you need to drive in reverse, make sure the area behind you is clear and only operate the SXS at low speed.

1. Bring the SXS to complete stop (the transmission cannot be shifted into reverse if the vehicle is moving). Make sure the transmission is in neutral.
2. Be sure there are no obstacles or people in the way.
3. While pulling the reverse lever and depressing the brake pedal, pull the downshift paddle once to shift into "R" (reverse) gear.

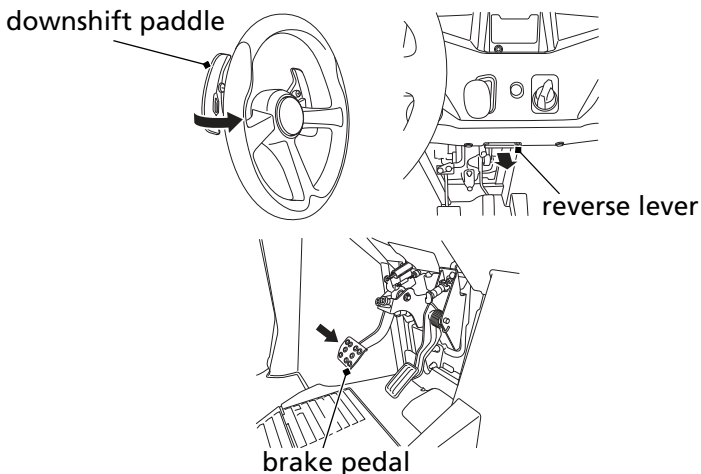

4. Make sure that the reverse indicator comes on.
5. Release the brake pedal and reverse lever.
6. Press the accelerator pedal gradually to increase speed.
7. To stop, lift off the accelerator pedal and press the brake pedal.
8. To shift out of reverse and into neutral, pull the upshift paddle once to shift into "N" (neutral) gear. Make sure that the reverse indicator goes off.