

# Clutch System

---

## Upper Adjustment

Minor adjustments are generally made with the upper clutch cable adjuster.

### LEFT HANDLEBAR

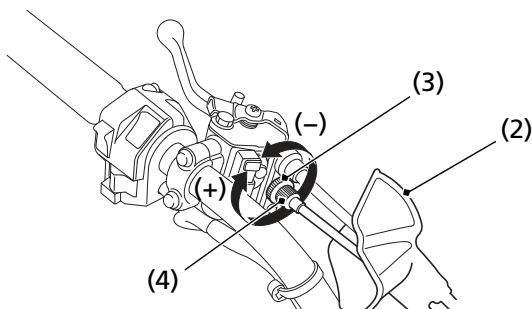

- (2) dust cover
- (3) upper lock nut
- (4) upper clutch cable adjuster
- (+) increase freeplay
- (-) decrease freeplay

1. Pull back the dust cover (2). Loosen the upper lock nut (3) and turn the upper clutch cable adjuster (4). Tighten the upper lock nut and check the adjustment.
2. If the cable adjuster is threaded out near its limit or the correct freeplay cannot be obtained using the cable adjuster, a major adjustment must be made. Loosen the upper lock nut and turn in the cable adjuster completely. Tighten the upper lock nut and pull on the dust cover.

If proper adjustment cannot be obtained or the clutch does not work correctly, the cable or clutch friction discs may be worn. See your dealer.