

Engine Oil

Checking & Adding Oil

Refer to *Safety Precautions* on page 79.

Check the engine oil level each day before operating your ATV and add if needed.

Before riding your ATV, check the engine oil level.

1. Park your ATV on a firm, level surface.
2. Start the engine in a well-ventilated area and let it idle for 3 – 5 minutes. Stop the engine and wait 2 – 3 minutes.
3. Remove the oil fill cap/dipstick (1) from the front crankcase cover and wipe it clean.
4. Insert the oil fill cap/dipstick without screwing it in, then remove the oil fill cap/dipstick and check the oil level. The oil level should be between the upper level mark (2) and the lower level mark (3) on the oil fill cap/dipstick.
5. If required, add the specified oil into the fill cap hole, up to the upper level mark on the oil fill cap/dipstick. Do not overfill.
6. Reinstall the oil fill cap/dipstick.

NOTICE

Running the engine with an improper oil level can cause serious engine damage.

LEFT SIDE

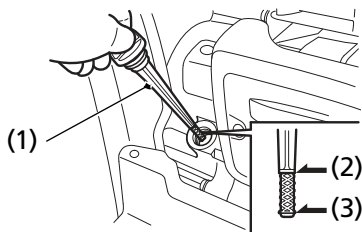

(1) oil fill cap/dipstick

(2) upper level mark

(3) lower level mark

(cont'd)