

## Adjustment

Refer to *Safety Precautions* on [page 73](#).

1. To adjust slack, use an Allen wrench (1) to loosen the rear axle holder fixing bolts (2).
2. Turn the adjuster (3) to decrease (A) or increase (B) chain slack.
3. Retighten the rear axle holder fixing bolts.

Rear axle holder fixing bolts torque:

**15 lbf·ft (21 N·m , 2.1 kgf·m)**

If a torque wrench is not used for installation, see your dealer as soon as possible to verify proper assembly.

### REAR

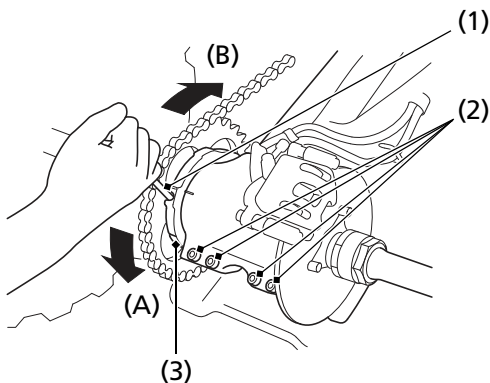

(1) Allen wrench

(2) rear axle holder fixing bolts

(3) adjuster