

Riding in Reverse

If you need to ride in reverse, make sure the area behind you is clear and only operate the ATV at low speed.

3 WARNING

Improperly operating in reverse could cause you to hit an obstacle or person behind you, resulting in serious injury.

Make sure there are no obstacles or people behind you before selecting reverse gear. When it is safe to proceed, go slowly.

1. Bring the vehicle to a complete stop, then make sure the transmission is in neutral.
2. Be sure there are no obstacles or people in the way.
3. Fully rotate the P/R lever (1) counterclockwise to engage the P/R lever with the reverse assist lever (2).
4. While continuing to hold the P/R lever, squeeze the rear brake lever/parking brake lever (3), then depress the shift lever once to shift into "R" (reverse) gear.
5. Make sure that the reverse indicator comes on and the gear position indicator shows "R".

LEFT HANDLEBAR

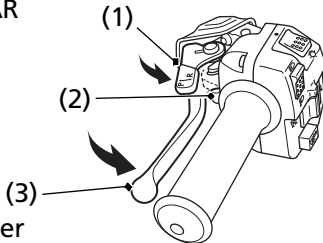

(1) P/R lever

(2) reverse assist lever

(3) rear brake lever/parking brake lever