

# Coolant

---

3. Remove the steering cover (4) and reserve tank cap (5).  
Always add coolant to the reserve tank. Do not attempt to add coolant by removing the radiator cap.
4. Add coolant to the reserve tank as required to bring the coolant level to the UPPER level mark.

## FRONT

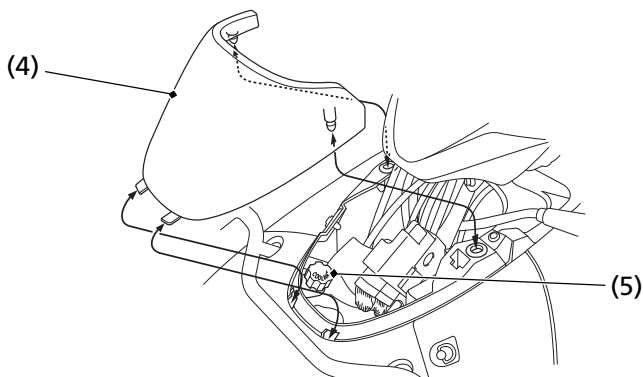

(4) steering cover

(5) reserve tank cap

5. After adding coolant, install the reserve tank cap and steering cover.