

Controls & Features

Front Brake Lever

The front brake lever (1) is used to slow or stop your ATV. To operate, pull the lever. For information on braking techniques, see page 63.

Rear Brake Lever/Parking Brake Lever

The rear brake lever/parking brake lever (2) is used to slow or stop your ATV. To operate, pull the lever. For information on braking techniques, see page 63.

LEFT & RIGHT HANDLEBAR

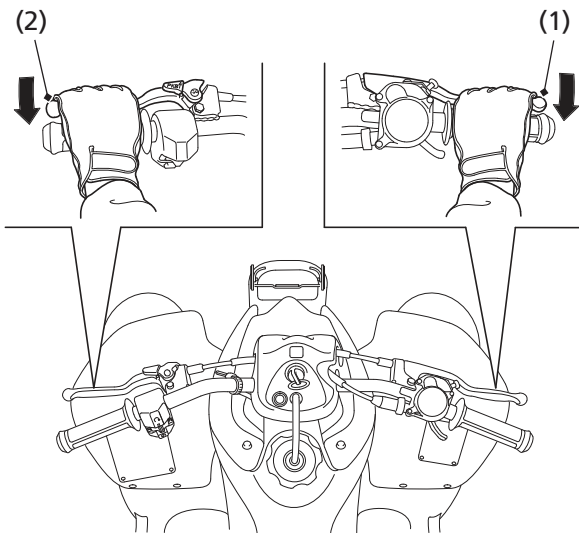

(1) front brake lever

(2) rear brake lever/parking brake lever