

Ignition Switch

Switches the electrical system on/off.

► Key can be removed when in the OFF position.

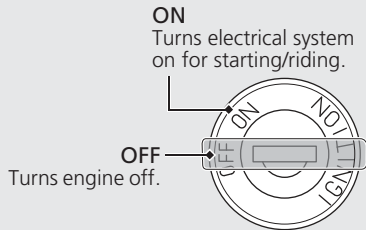

Steering Lock

Lock the steering when parking to help prevent theft.

A U-shaped wheel lock or similar device is also recommended.

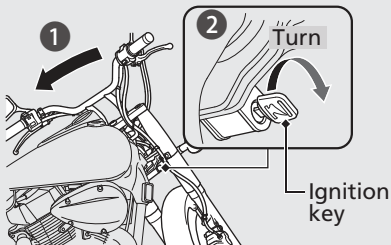

Locking

- 1 Turn the handlebars all the way to the left.
- 2 Insert the key in the steering lock and turn it 180 degrees clockwise.
- 3 Remove the key.

Unlocking

Insert the key and turn it 180 degrees counterclockwise.