

FRONT BRAKE MASTER CYLINDER

Ref. No.	L.O.N.	(Relative ref. Number)	Description	F.R.T.
1	6151B2		SWITCH, FRONT STOP	0.2
2	7121A0		HOSE, FRONT BRAKE	0.4
6	712105		-INCLUDES: Bleed brakes CYLINDER, FRONT BRAKE MASTER	0.5
10	7121G6		-INCLUDES: Bleed brakes DIAPHRAGM, FRONT BRAKE MASTER CYLINDER	0.1
12	7121G9		PISTON SET, FRONT BRAKE MASTER	0.4
13	8101C7		-INCLUDES: Bleed brakes LEVER, HANDLE :RIGHT	0.1
	8101F5		LEVER, HANDLE :BOTH	0.3

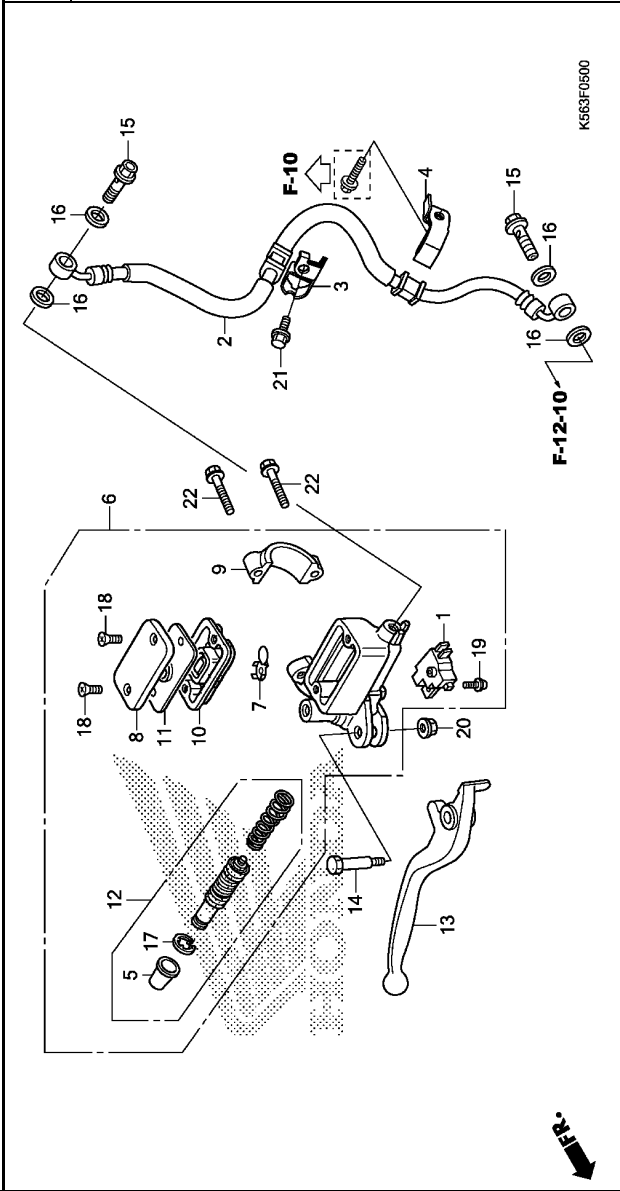

Ref. No.	Part No.	Description	Reqd. QTY	Serial No.	Parts catalogue code
			FS 150R G		
1	35340-KWB-601	SWITCH ASSY., FR. STOP	1		
2	45126-K56-N01	HOSE COMP., FR. BRAKE	1		
3	45155-K56-N00	CLAMPER A, FR. BRAKE HOSE	1		
4	45156-K56-N00	CLAMPER B, FR. BRAKE HOSE	1		
5	45504-410-003	BOOT COMP.	1		
6	45510-KZY-702	CYLINDER SUB ASSY., FR. BRAKE MASTER(NISSIN)	1		
7	45512-MA6-006	PROTECTOR	1		
8	45513-HA2-006	CAP, MASTER CYLINDER	1		
9	45517-166-006	HOLDER, MASTER CYLINDER	1		
10	45520-GE2-006	DIAPHRAGM	1		
11	45521-K21-901	PLATE, DIAPHRAGM	1		
12	45530-471-831	CYLINDER SET, MASTER	1		
13	53175-KSP-B51	LEVER, R. STEERING HANDLE	1		
14	90114-KGH-900	BOLT, HANDLE LEVER PIVOT	1		
15	90145-GAZ-981	BOLT, OIL, 10X22	2		
16	90545-300-000	WASHER, OIL BOLT	4		
17	90651-MA5-671	CIRCLIP	1		
18	93600-04012-1G	SCREW, FLAT, 4X12	2		
19	93893-04012-17	SCREW-WASHER, 4X12	1		
20	94050-06000	NUT, FLANGE, 6MM	1		
21	96001-06012-07	BOLT, FLANGE, 6X12	1		
22	96001-06022-07	BOLT, FLANGE, 6X22	2		