

Radiator Disassembly/Assembly

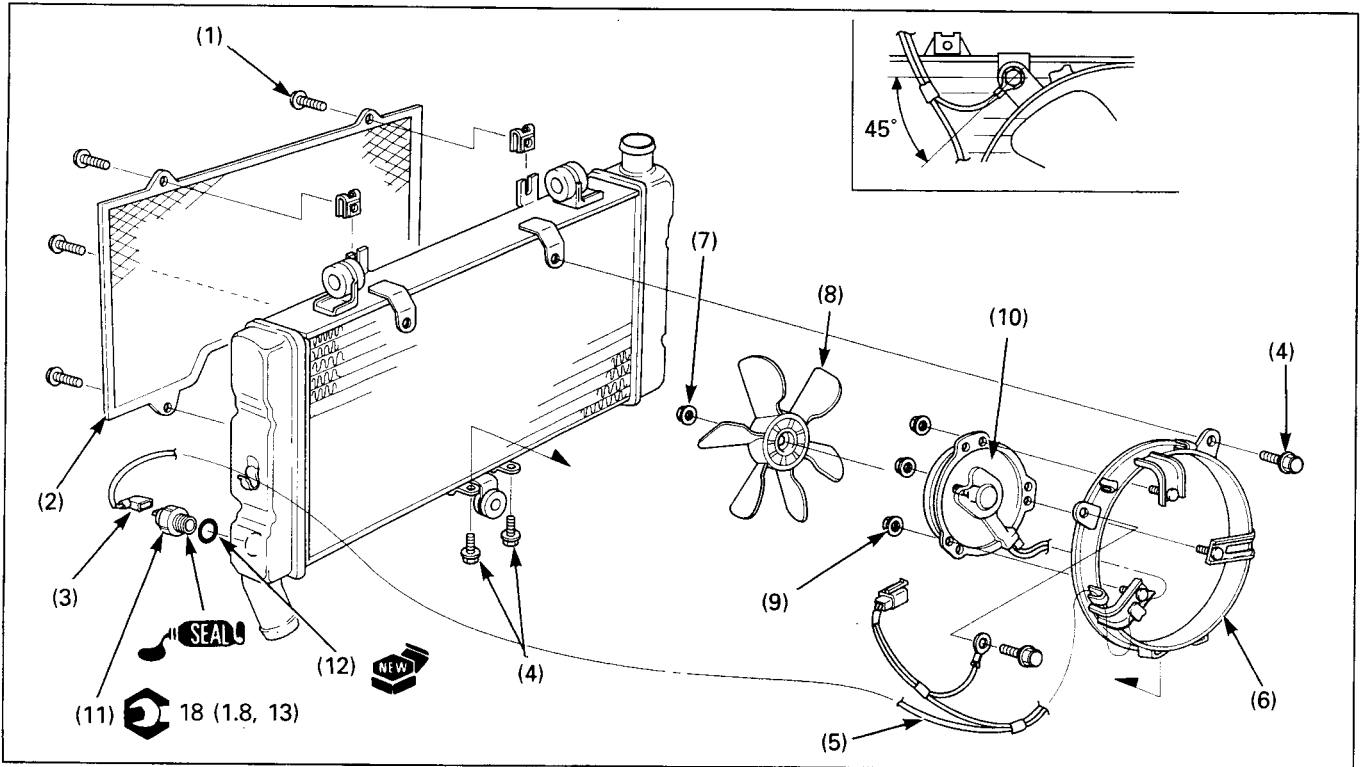

Requisite Service

- Radiator removal/installation (page 6-4)

Procedure	Q'ty	Remarks
Disassembly Order		
(1) Radiator grill screw	4	Assembly is in the reverse order of disassembly. At installation, attach the ground wire as shown. At installation, align the fan motor groove with the fan motor shaft.
(2) Radiator grill	1	
(3) Fan motor switch connector	1	
(4) SH bolt	4	
(5) Fan motor wire harness	1	
(6) Shroud	1	
(7) Cooling fan nut	1	
(8) Cooling fan	1	
(9) Fan motor nut	3	
(10) Fan motor	1	
(11) Fan motor switch	1	
(12) O-ring	1	