

# FRONT WHEEL/SUSPENSION/STEERING

## INSTALLATION

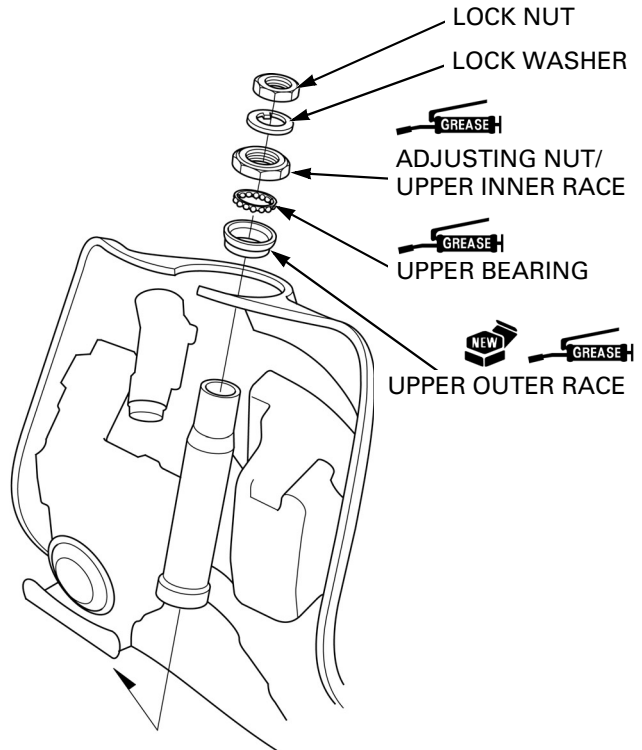
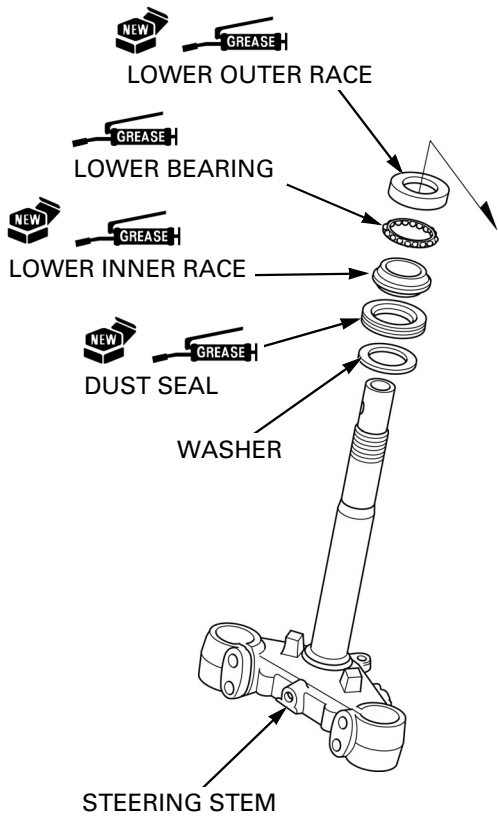

GREASE with extreme pressure agent (recommended: EXCELIGHT EP2 manufactured by KYODO YUSHI, japan or Shell ALVANIA EP2 or equivalent)

Install the washer to the steering stem.

*Do not damage the bearing rolling area of the lower inner race.*

Install a new lower inner race using the following tool and hydraulic press.

**TOOL:**

**Inner driver, 30 mm**

**07746-0030300**

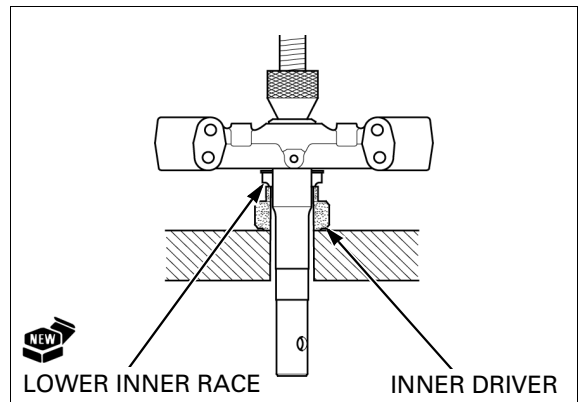

Install a new dust seal to the lower inner race groove.

Apply grease with extreme pressure agent (recommended: EXCELIGHT EP2 manufactured by KYODO YUSHI, japan or Shell ALVANIA EP2 or equivalent) to the dust seal lip.

